

Rectangle Garden Layout

40 by 32 Feet

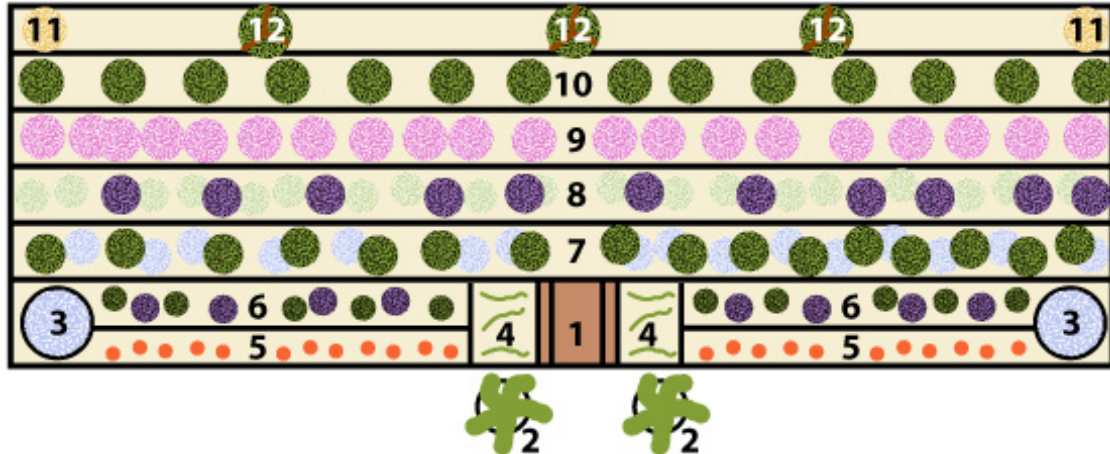

Layout Key

- 1- Grapevine arbor (see image below for assembly)
- 2- Mint plants in pots
- 3- Annuals in hanging pots
- 4- Grapevines in 6-by-4-foot beds
- 5- Alpine strawberries, 2-foot wide row
- 6- Chives and purple basil alternating, 4-foot wide row
- 7- Purple salvia and evening primrose alternating, 4-foot wide row
- 8- Echinacea and butterfly weed alternating, 4-foot wide row
- 9- Asters, 4-foot wide row
- 10- Rosemary shrubs, 4-foot wide row
- 11- Peach trees
- 12- Eight-foot high pole bean trellises with beans planted (see images below for assembly)

Trellis

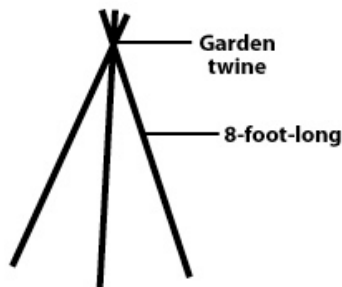

Arbor

